



— Redefining IT Parks —

PRICE LIST

OFFICE SPACE
(T O W E R - D)

Basic Sale Price	₹ 11,500/- Sq.ft.	
Additional Charges		
Corner PLC	200.00	Per Sq.ft.
Road Facing	200.00	Per Sq.ft.
Plaza Facing	300.00	Per Sq.ft.
Lease Rent /IFMS/EEC/FFC	700.00	Per Sq.ft.

Payment Plan

1	On Booking	10% of BSP	
2	Within 30 Days of Booking	15% of BSP	
3	On Casting of 10th Floor	25% of BSP	
3	On Casting of 16th Floor	15% of BSP	
3	On Casting of 22nd Floor	15% of BSP	
4	On Completion of Structure	10% of BSP	+50% Additional Charges
5	On Offer of Possession	10% of BSP	+50% Additional Charges

NOTE

1. Prices and Plans are subject to revision at company's discretion.
2. All the payments to be made through Cheque/DD in favour of "HSL SOFTWARE PRIVATE LIMITED"
3. All the additional charges to be paid on offer of possession
4. HVAC charges to be charged extra, if applicable.
5. Air conditioning will be provided by Dx System. Charges for the indoor unit will be Rs 60,000 per ton (Rs 20,000 – for every 0.5 ton in addition to 1.0-ton charges) +GST or any other applicable taxes. It is mandatory to take minimum 1 ton AC load for covered area up to 100 SQFT. These rates are as per current market rate. Any escalation in the rates of the equipment at the time of possession shall be charged extra.
6. **Govt. Taxes extra as applicable**

Note: This Payment Plan is Applicable for Tower-D Office Space Only

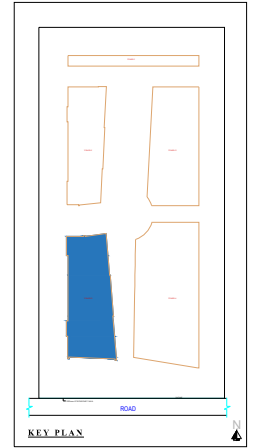
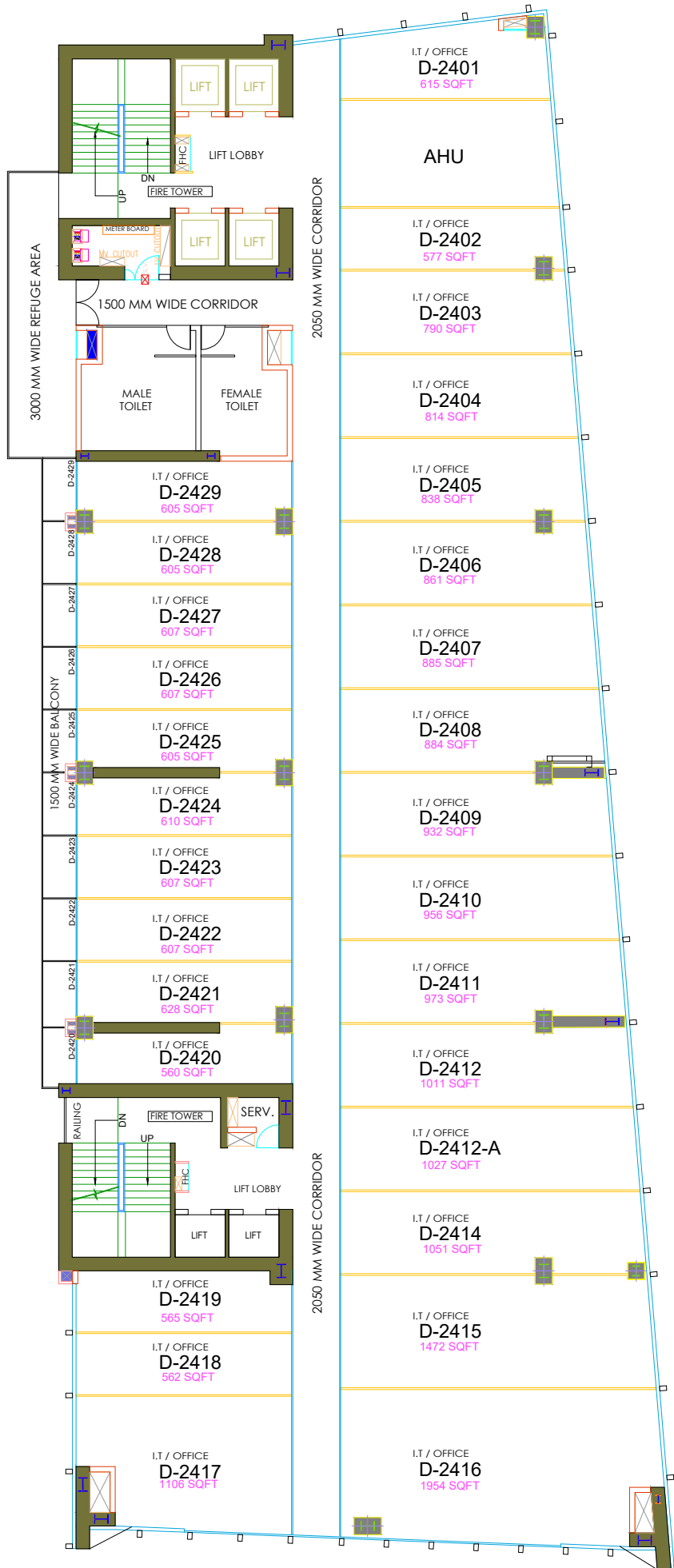

PROPOSED

ITHUM'S 62
SECTOR 62- NOIDA

TOWER-D 24TH FLOOR PLAN_R0

